

RIJKSWEG 62 IN DUIVEN

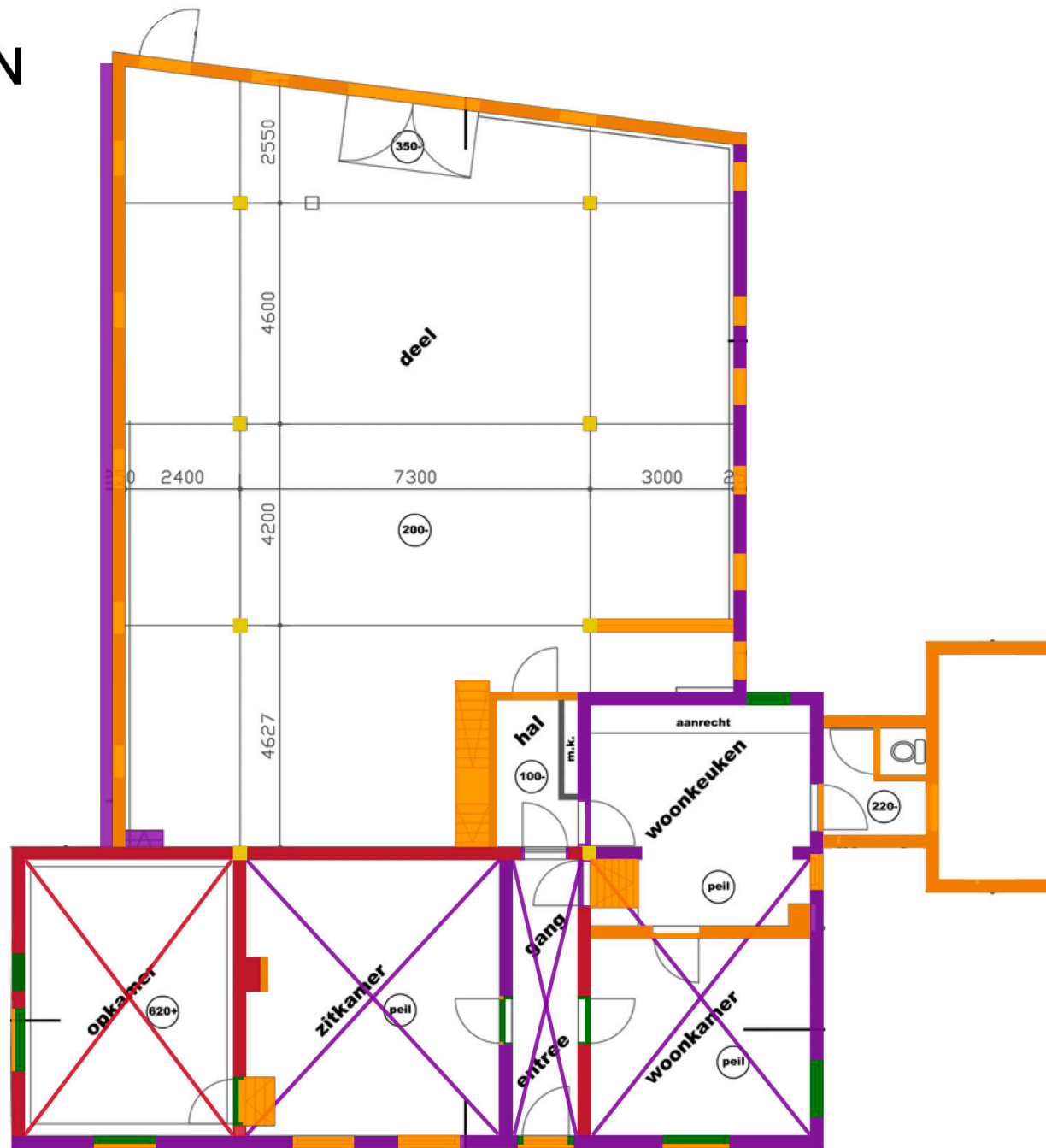

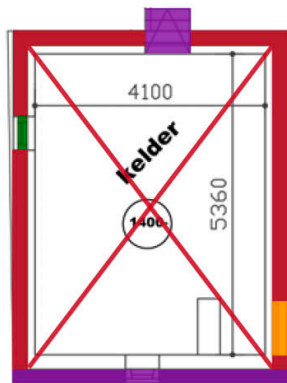



Faseringsplattengrond begane grond

- late 16^e- of 17^e eeuw: bouw boerderij
- 17^e eeuw: aanbouw landheerskamer
- 18^e eeuw: rechter aanbouw en voorgevel
- 19^e eeuw: modernisering vensters woongedeelte
- 20^e eeuw: latere veranderingen
- datering balklaag of kap



RIJKSWEG 62 IN DUIVEN



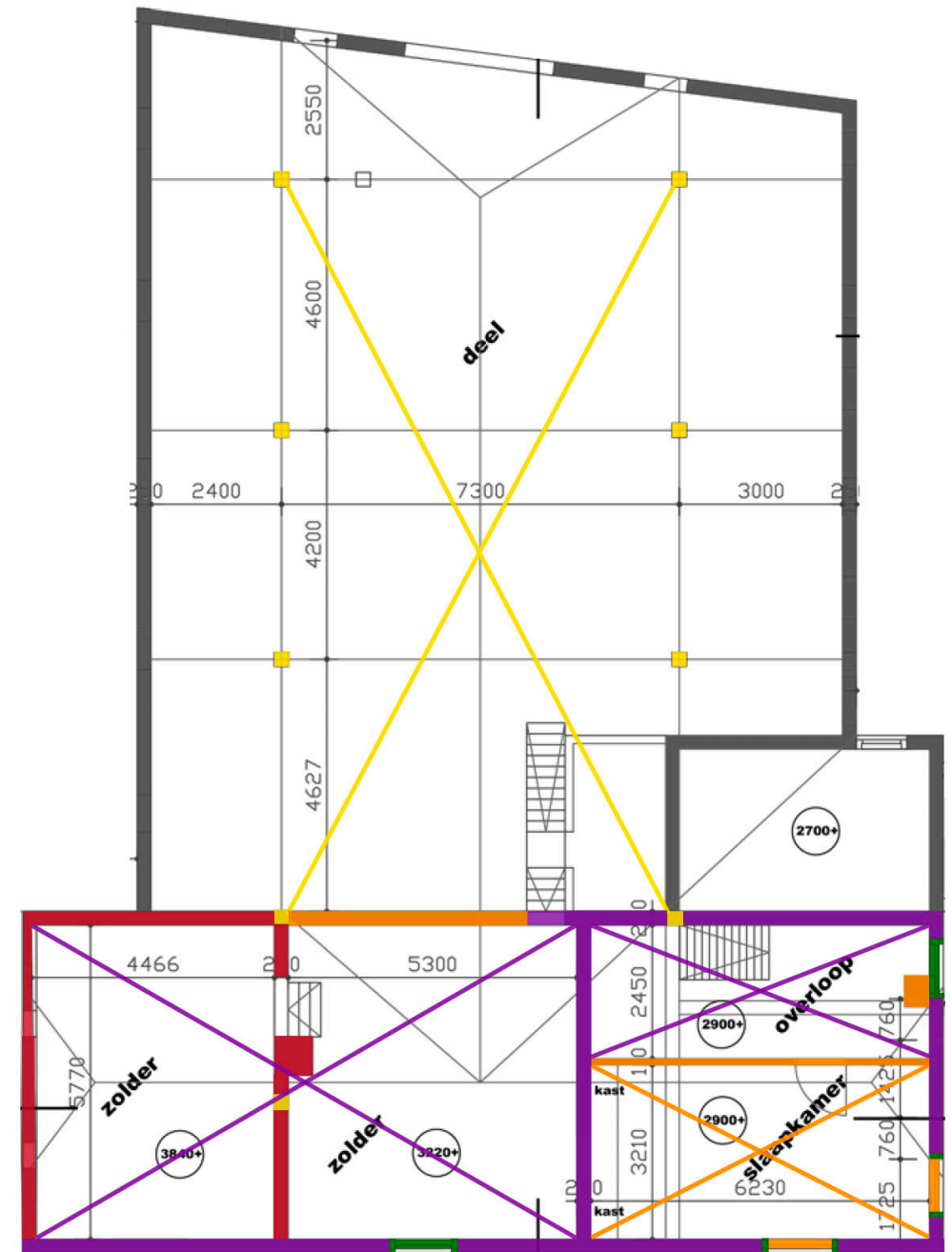
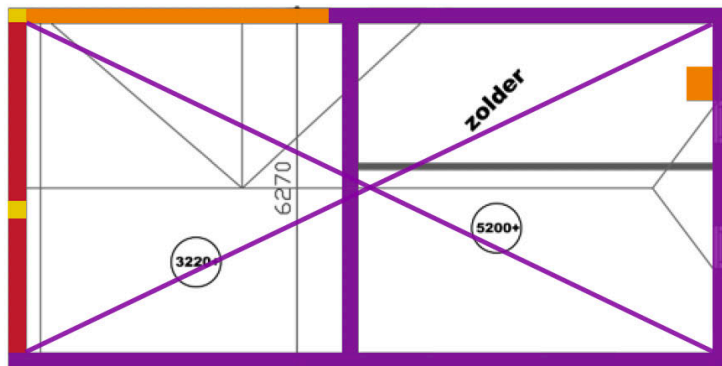

Faseringsplattegrond verdieping en zolder

-  late 16^e- of 17^e eeuw: bouw boerderij
-  17^e eeuw: aanbouw landheerskamer
-  18^e eeuw: rechter aanbouw en voorgevel
-  19^e eeuw: modernisering vensters woongedeelte
-  20^e eeuw: latere veranderingen
-  datering balklaag of kap



RIJKSWEG 62 IN DUIVEN



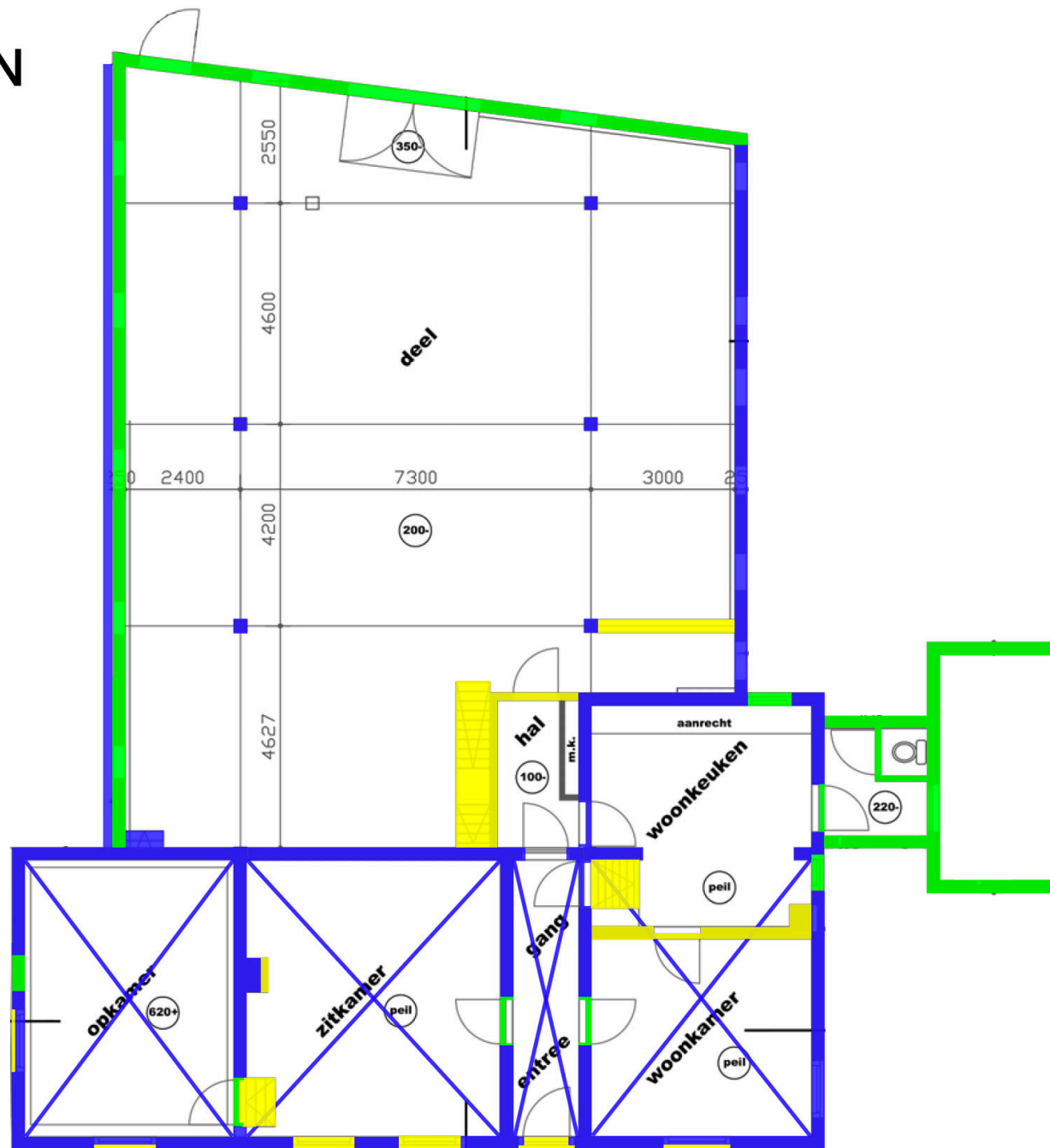
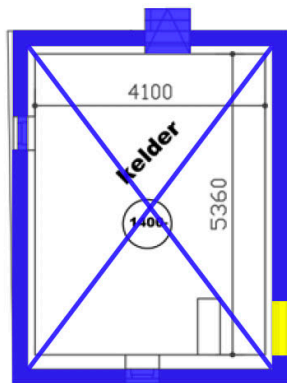

Waarderingsplattegrond begane grond

-  hoge monumentwaarden
-  positieve monumentwaarden
-  indifferente monumentwaarden
-  monumentwaarden van balklaag of kap

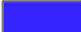

RIJKSWEG 62 IN DUIVEN

Waarderingsplattegrond verdieping en zolder

-  hoge monumentwaarden
-  positieve monumentwaarden
-  indifferente monumentwaarden
-  monumentwaarden van balklaag of kap

