

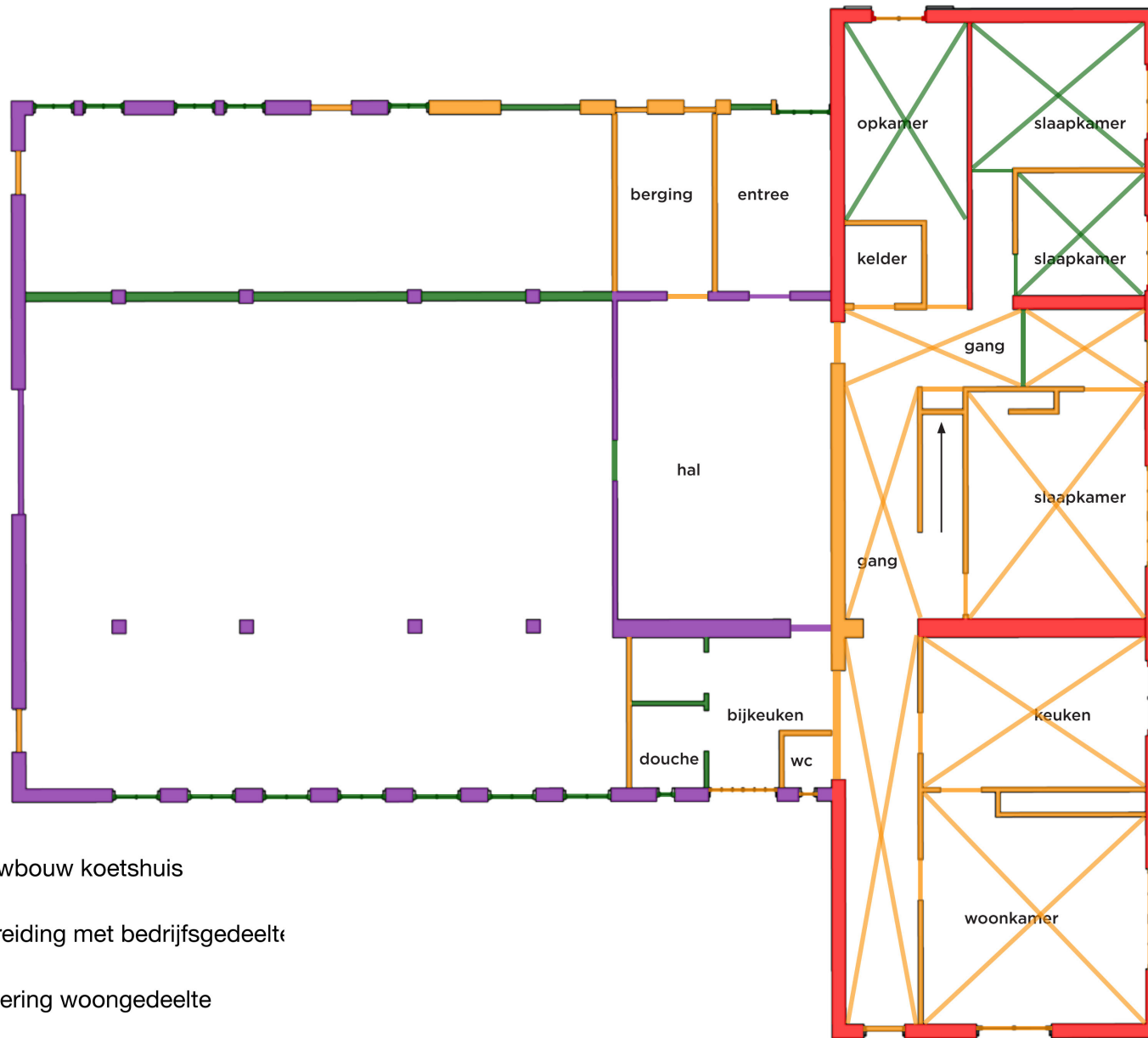





FASERING

begane grond





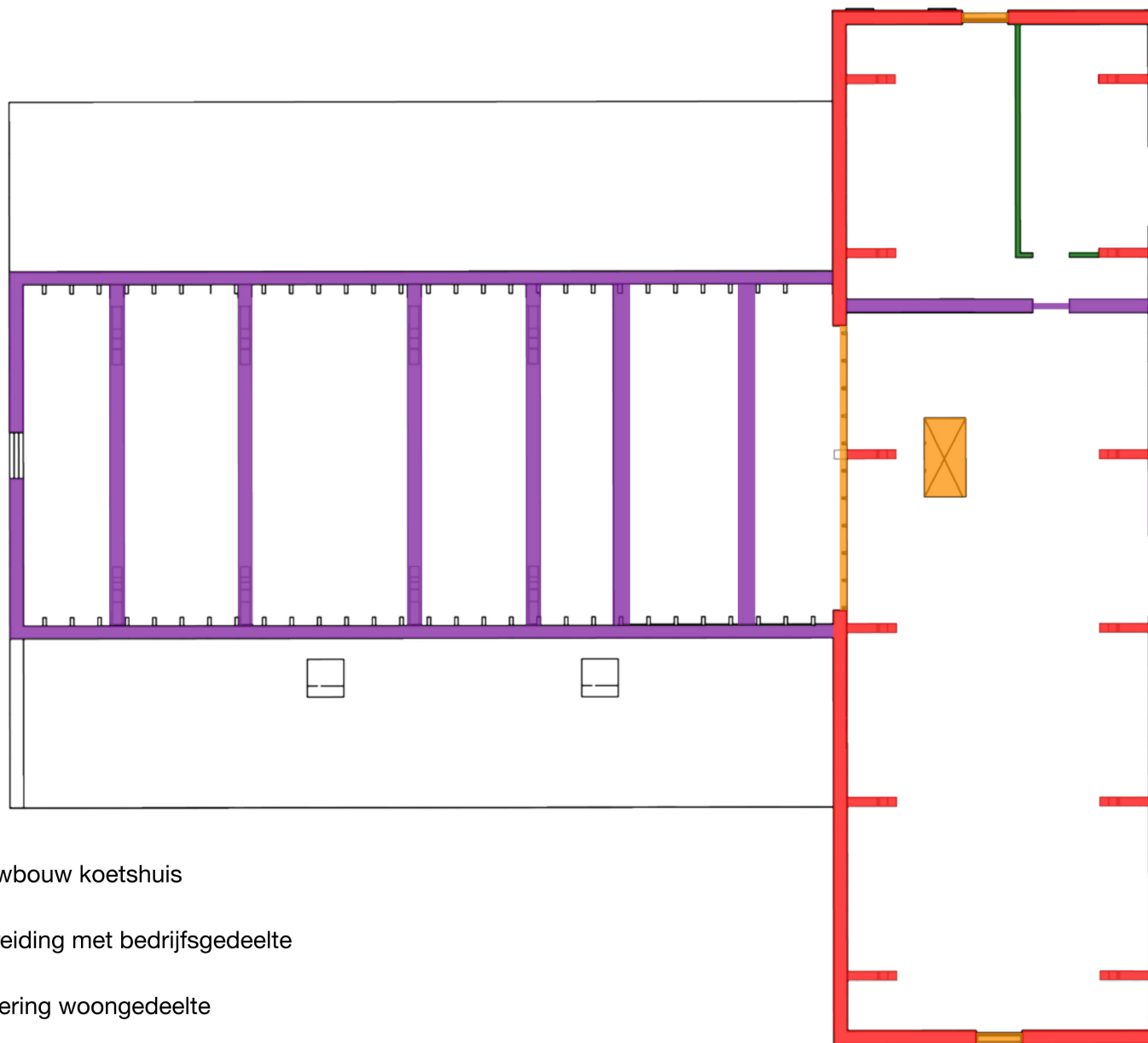

-  18e eeuw: nieuwbouw koetshuis
-  voor 1832: uitbreiding met bedrijfsgedeelte
-  1931: modernisering woongedeelte
-  1950-heden: latere veranderingen
-  datering plafond

FASERING

zolder





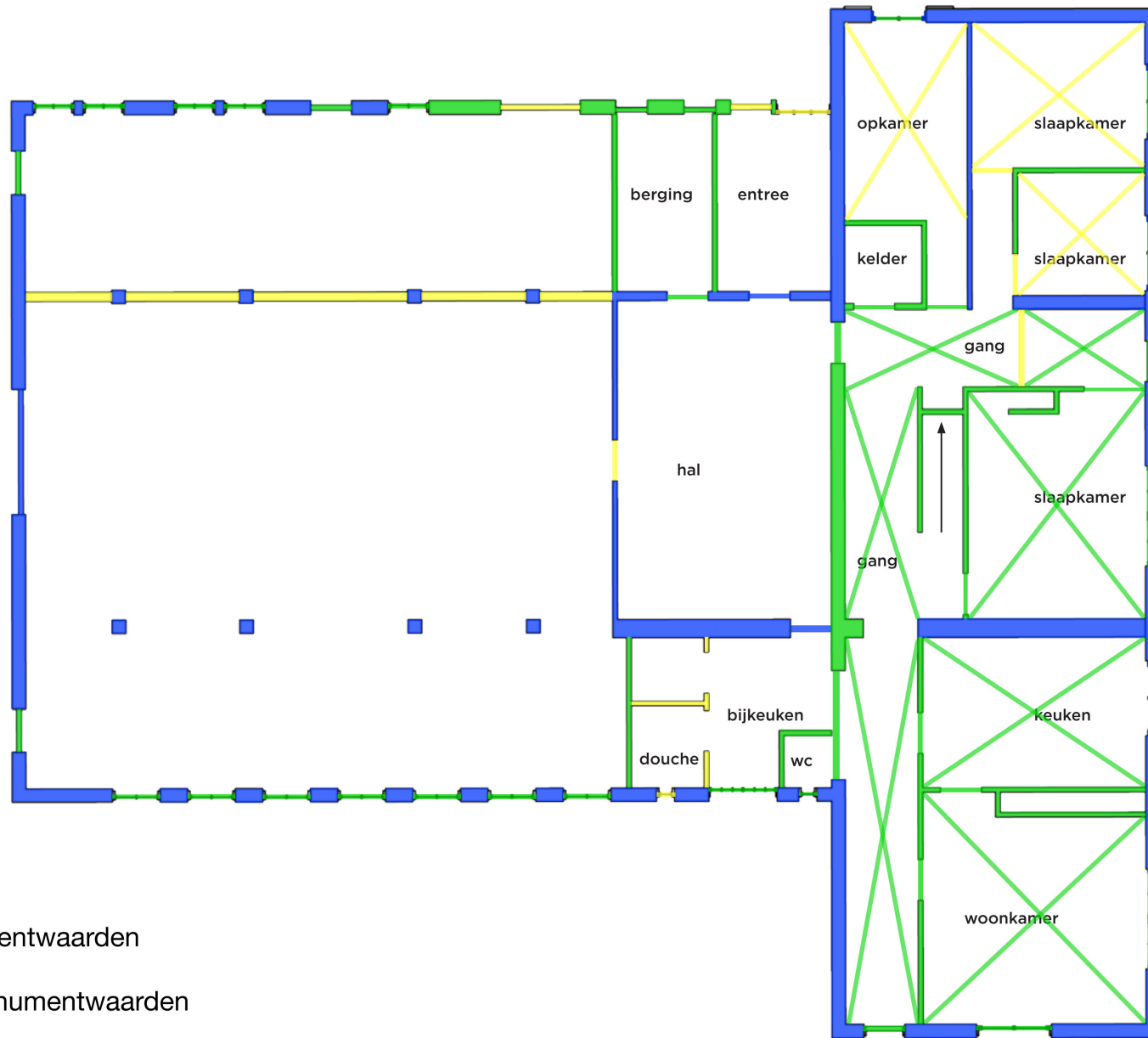

-  18e eeuw: nieuwbouw koetshuis
-  voor 1832: uitbreiding met bedrijfsgebouwe
-  1931: modernisering woongedeelte
-  1950-heden: latere veranderingen
-  datering plafond

WAARDERING

begane grond

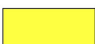



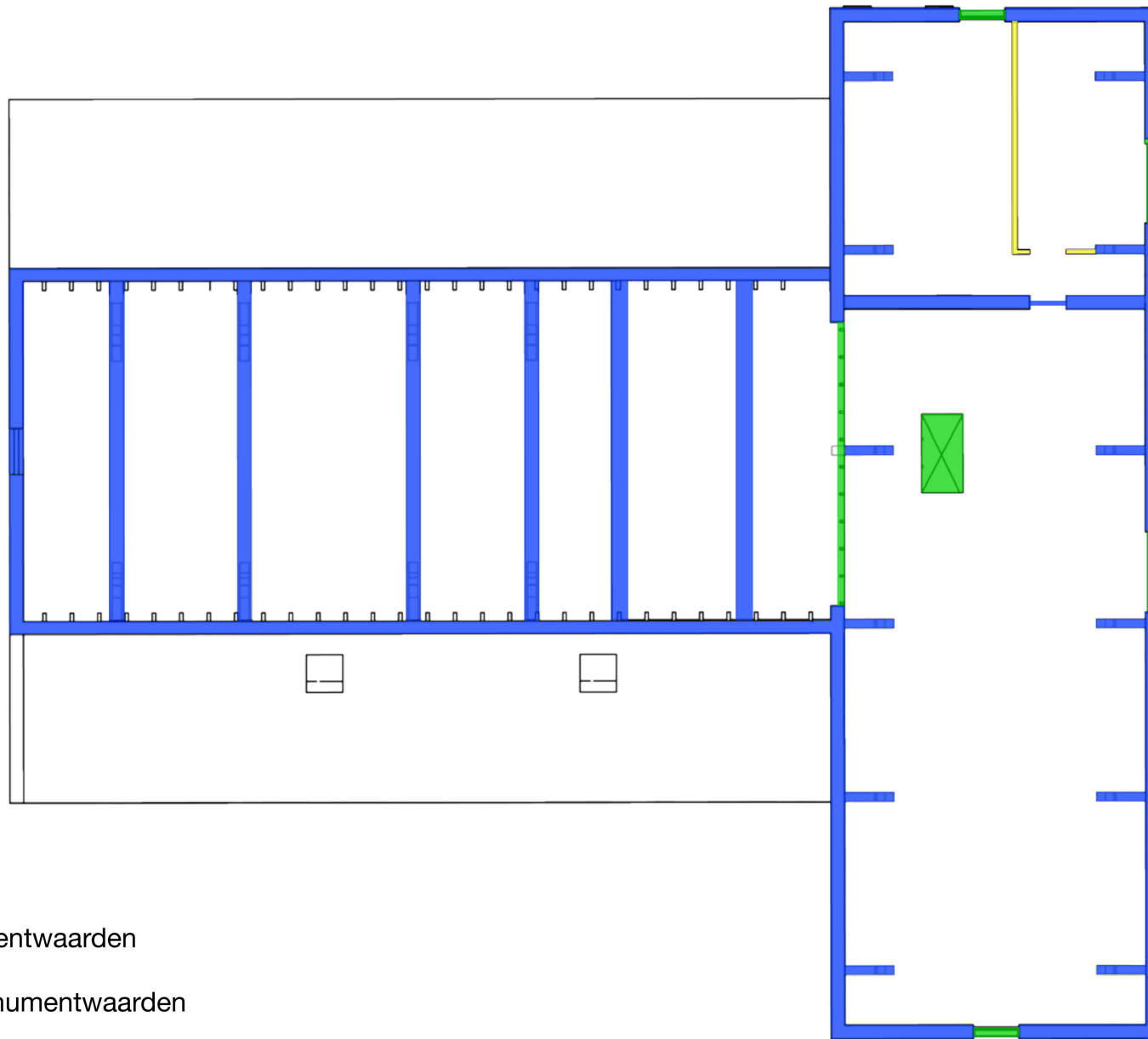

-  hoge monumentwaarden
-  positieve monumentwaarden
-  indifferente monumentwaarden
-  monumentwaarden plafond

WAARDERING

zolder



-  hoge monumentwaarden
-  positieve monumentwaarden
-  indifferente monumentwaarden
-  monumentwaarden plafond