



EXTREME DURABILITY IN HARSH ENVIRONMENTS

EXTREME

INDUCTIVE SENSORS

KEY ADVANTAGES

- ✓ Mechanically and chemically extremely robust
- ✓ Corrosion resistant
- ✓ IP 68 and IP 69K, water resistant
- ✓ Pressure resistant up to 100 bar (1451 psi)
- ✓  IO-Link

RANGE OVERVIEW

Housing size

Full Inox

EXTREME

M8

p. 83-84

M12

p. 84-86

M18

p. 87-88

M30

p. 89-90

C23

p. 91

FAMILY

HOUSING SIZE

OPERATING DISTANCE MM

INDUCTIVE

WIRING DIAGRAMS

PNP NO

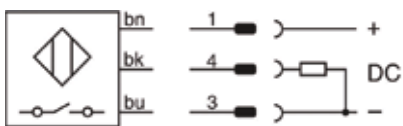

PNP NC

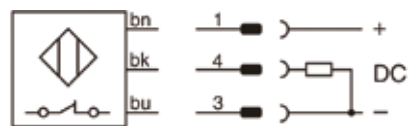

NPN NO

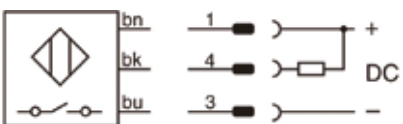

DATA

Sensing face material

Housing material

Connection

Degree of protection

Mounting

Max. switching frequency

Supply voltage range

Ambient temperature range

Output current

PNP NO

NPN NO

PNP NC

Other types available

EXTREME

FULL INOX	FULL INOX	FULL INOX	FULL INOX
M8	M8	M8	M8
3	3	3	6

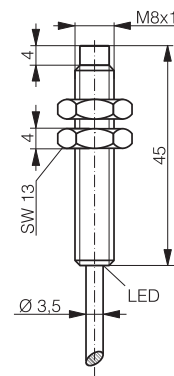
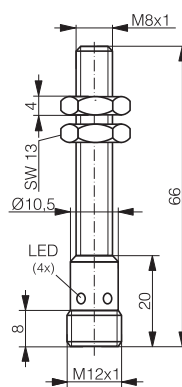
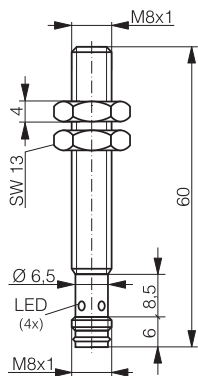
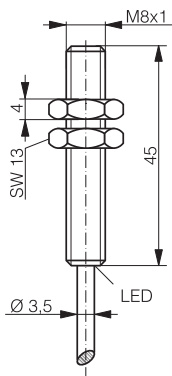

IO-Link	IO-Link	IO-Link	IO-Link
Stainless steel V2A	Stainless steel V2A	Stainless steel V2A	Stainless steel V2A
Stainless steel V2A	Stainless steel V2A	Stainless steel V2A	Stainless steel V2A
PUR cable	Connector S8	Connector S12	PUR cable
IP 68	IP 67	IP 67	IP 68
Embeddable	Embeddable	Embeddable	Non-embeddable
1000 Hz	1000 Hz	1000 Hz	700 Hz
10 ... 30 VDC	10 ... 30 VDC	10 ... 30 VDC	10 ... 30 VDC
-25 ... +85°C / -13 ... +185°F	-25 ... +85°C / -13 ... +185°F	-25 ... +85°C / -13 ... +185°F	-25 ... +85°C / -13 ... +185°F
≤ 200 mA	≤ 200 mA	≤ 200 mA	≤ 200 mA
DW-AD-703-M8	DW-AS-703-M8-001	DW-AS-703-M8	DW-AD-713-M8
DW-AD-701-M8	DW-AS-701-M8-001	DW-AS-701-M8	DW-AD-711-M8
DW-AD-704-M8			DW-AD-714-M8
NPN NC, pigtail	PNP NC, NPN NC	PNP NC, NPN NC	NPN NC

Inductive

Photoelectric

Safety

RFID

Connectivity

Accessories

Glossary

Index

EXTREME

INDUCTIVE

FAMILY	FULL INOX	FULL INOX	FULL INOX
HOUSING SIZE	M8	M8	M12
OPERATING DISTANCE MM	6	6	2 (4)

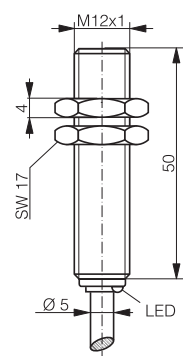
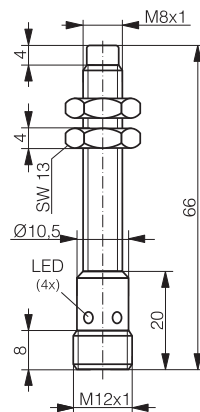
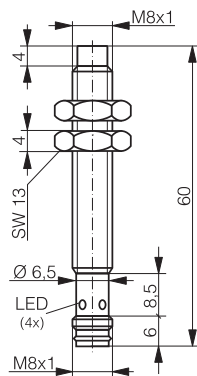

DATA	IO-Link	IO-Link	IO-Link
Sensing face material	Stainless steel V2A	Stainless steel V2A	Stainless steel V2A
Housing material	Stainless steel V2A	Stainless steel V2A	Stainless steel V2A
Connection	Connector S8	Connector S12	PUR cable
Degree of protection	IP 67	IP 67	IP 68 / IP 69K
Mounting	Non-embeddable	Non-embeddable	Embeddable
Max. switching frequency	700 Hz	700 Hz	850 Hz
Supply voltage range	10 ... 30 VDC	10 ... 30 VDC	10 ... 30 VDC
Ambient temperature range	-25 ... +85°C / -13 ... +185°F	-25 ... +85°C / -13 ... +185°F	-25 ... +85°C / -13 ... +185°F
Output current	≤ 200 mA	≤ 200 mA	≤ 200 mA
PNP NO	DW-AS-713-M8-001	DW-AS-713-M8	DW-AD-703-M12-303
NPN NO	DW-AS-711-M8-001	DW-AS-711-M8	DW-AD-701-M12-303
PNP NC			
Other types available	PNP NC, NPN NC	PNP NC, NPN NC	PNP NC, NPN NC, non-embeddable (Sn 4 mm)

EXTREME

FULL INOX	FULL INOX	FULL INOX	FULL INOX	Inductive
M12	M12	M12	M12	
2 (4)	6	6	10	

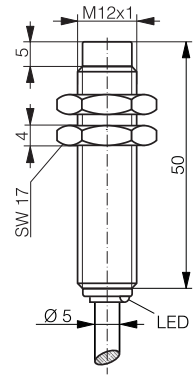
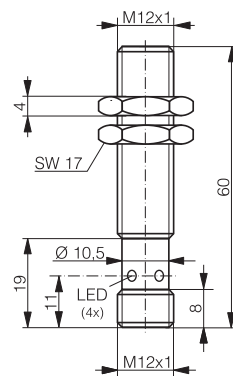
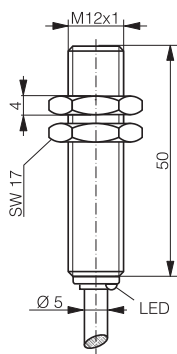
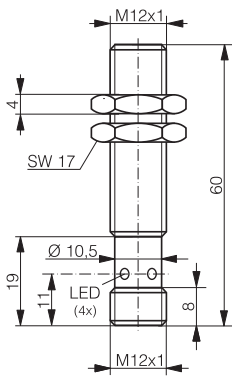

Photoelectric

Safety

RFID

Connectivity

IO-Link	IO-Link	IO-Link	IO-Link	Accessories
Stainless steel V2A	Stainless steel V2A	Stainless steel V2A	Stainless steel V2A	Glossary
Stainless steel V2A	Stainless steel V2A	Stainless steel V2A	Stainless steel V2A	
Connector S12	PUR cable	Connector S12	PUR cable	
IP 68 / IP 69K	IP 68 / IP 69K	IP 68 / IP 69K	IP 68 / IP 69K	
Embeddable	Embeddable	Embeddable	Non-embeddable	
850 Hz	600 Hz	600 Hz	400 Hz	
10 ... 30 VDC	10 ... 30 VDC	10 ... 30 VDC	10 ... 30 VDC	
-25 ... +85°C / -13 ... +185°F	-25 ... +85°C / -13 ... +185°F	-25 ... +85°C / -13 ... +185°F	-25 ... +85°C / -13 ... +185°F	
≤ 200 mA	≤ 200 mA	≤ 200 mA	≤ 200 mA	
DW-AS-703-M12-303	DW-AD-703-M12	DW-AS-703-M12	DW-AD-713-M12	
DW-AS-701-M12-303	DW-AD-701-M12	DW-AS-701-M12	DW-AD-711-M12	
		DW-AS-704-M12		
PNP NC, NPN NC, non-embeddable (Sn 4 mm)	PNP NC, NPN NC	NPN NC	PNP NC, NPN NC	

EXTREME

INDUCTIVE

FAMILY	FULL INOX	FULL INOX	FULL INOX
HOUSING SIZE	M12	M12	M12
OPERATING DISTANCE MM	10	15	15

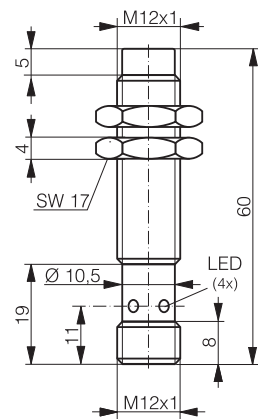
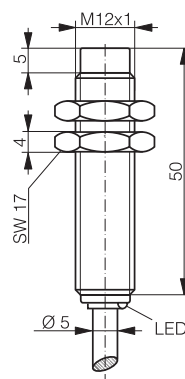
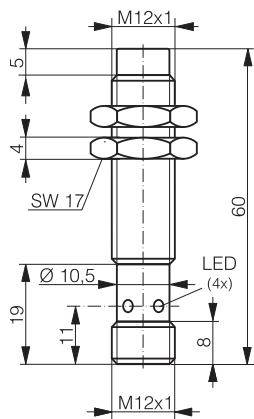

DATA	IO-Link	IO-Link	IO-Link
Sensing face material	Stainless steel V2A	Stainless steel V2A	Stainless steel V2A
Housing material	Stainless steel V2A	Stainless steel V2A	Stainless steel V2A
Connection	Connector S12	PUR cable	Connector S12
Degree of protection	IP 68 / IP 69K	IP 68 / IP 69K	IP 68 / IP 69K
Mounting	Non-embeddable	Non-embeddable	Non-embeddable
Max. switching frequency	400 Hz	300 Hz	300 Hz
Supply voltage range	10 ... 30 VDC	10 ... 30 VDC	10 ... 30 VDC
Ambient temperature range	-25 ... +85°C / -13 ... +185°F	-25 ... +85°C / -13 ... +185°F	-25 ... +85°C / -13 ... +185°F
Output current	≤ 200 mA	≤ 200 mA	≤ 200 mA
PNP NO	DW-AS-713-M12	DW-AD-733-M12	DW-AS-733-M12
NPN NO	DW-AS-711-M12	DW-AD-731-M12	DW-AS-731-M12
PNP NC			
Other types available	PNP NC, NPN NC		

EXTREME

FULL INOX	FULL INOX	FULL INOX	FULL INOX
M18	M18	M18	M18
5	5 (8)	10	10

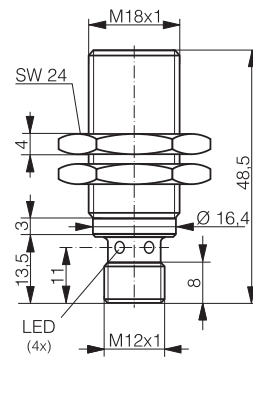
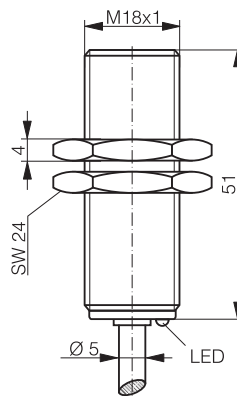
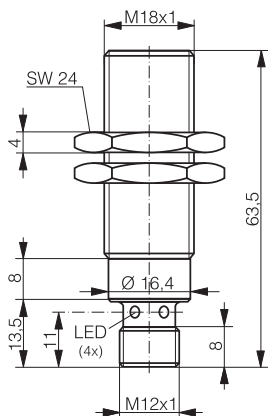
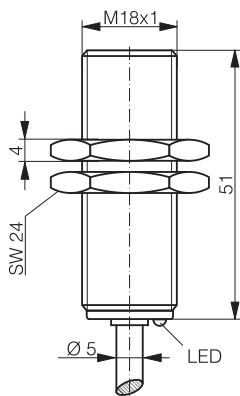

IO-Link	IO-Link	IO-Link	IO-Link
Stainless steel V2A	Stainless steel V2A	Stainless steel V2A	Stainless steel V2A
Stainless steel V2A	Stainless steel V2A	Stainless steel V2A	Stainless steel V2A
PUR cable	Connector S12	PUR cable	Connector S12
IP 68 / IP 69K	IP 68 / IP 69K	IP 68 / IP 69K	IP 68 / IP 69K
Embeddable	Embeddable	Embeddable	Embeddable
500 Hz	500 Hz	200 Hz	200 Hz
10 ... 30 VDC	10 ... 30 VDC	10 ... 30 VDC	10 ... 30 VDC
-25 ... +85°C / -13 ... +185°F	-25 ... +85°C / -13 ... +185°F	-25 ... +85°C / -13 ... +185°F	-25 ... +85°C / -13 ... +185°F
≤ 200 mA	≤ 200 mA	≤ 200 mA	≤ 200 mA
DW-AD-703-M18-303	DW-AS-703-M18-303	DW-AD-703-M18	DW-AS-703-M18-120
DW-AD-701-M18-303	DW-AS-701-M18-303	DW-AD-701-M18	DW-AS-701-M18-120
		DW-AD-704-M18	
PNP NC, NPN NC	PNP NC, NPN NC, non-embeddable (Sn 8 mm)	NPN NC, length 35 mm	PNP NC, NPN NC

EXTREME

INDUCTIVE

FAMILY	FULL INOX	FULL INOX	FULL INOX
HOUSING SIZE	M18	M18	M18
OPERATING DISTANCE MM	10	20	20

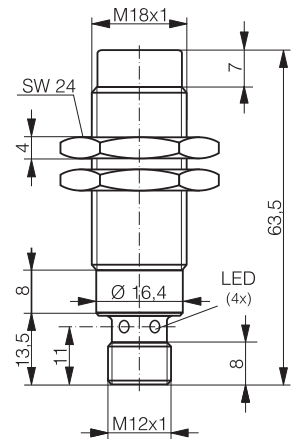
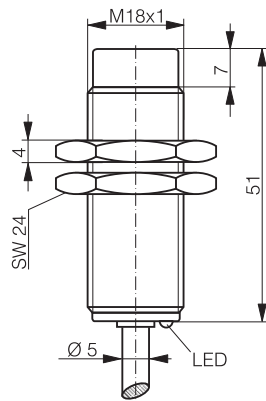
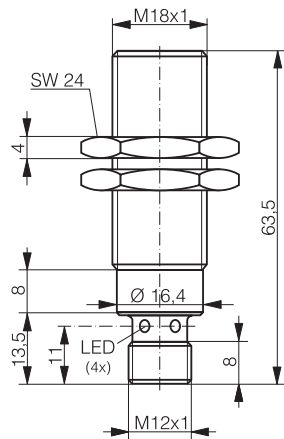

DATA	IO-Link	IO-Link	IO-Link
Sensing face material	Stainless steel V2A	Stainless steel V2A	Stainless steel V2A
Housing material	Stainless steel V2A	Stainless steel V2A	Stainless steel V2A
Connection	Connector S12	PUR cable	Connector S12
Degree of protection	IP 68 / IP 69K	IP 68 / IP 69K	IP 68 / IP 69K
Mounting	Embeddable	Non-embeddable	Non-embeddable
Max. switching frequency	200 Hz	200 Hz	200 Hz
Supply voltage range	10 ... 30 VDC	10 ... 30 VDC	10 ... 30 VDC
Ambient temperature range	-25 ... +85°C / -13 ... +185°F	-25 ... +85°C / -13 ... +185°F	-25 ... +85°C / -13 ... +185°F
Output current	≤ 200 mA	≤ 200 mA	≤ 200 mA
PNP NO	DW-AS-703-M18-002	DW-AD-713-M18	DW-AS-713-M18-002
NPN NO	DW-AS-701-M18-002	DW-AD-711-M18	DW-AS-711-M18-002
PNP NC	DW-AS-704-M18-002		
Other types available	NPN NC	PNP NC, NPN NC	PNP NC, NPN NC

EXTREME

FULL INOX	FULL INOX	FULL INOX	FULL INOX
M30	M30	M30	M30
10	10	20	20

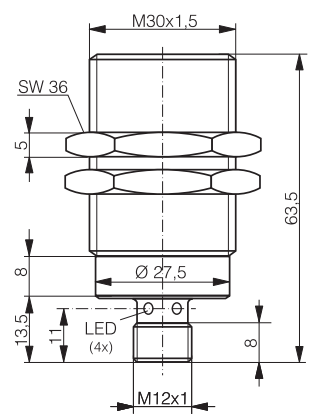
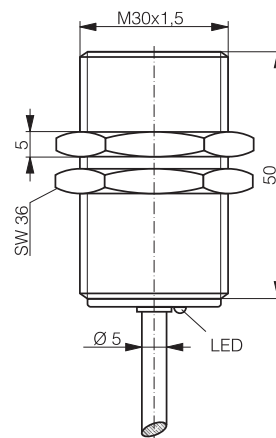
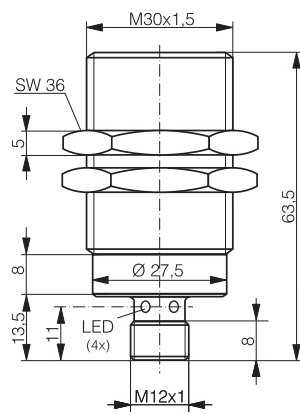
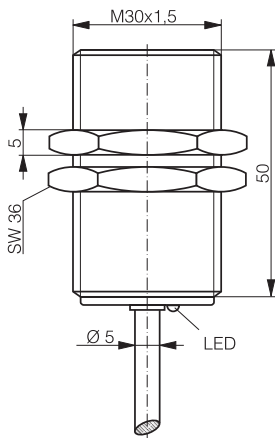

IO-Link	IO-Link	IO-Link	IO-Link
Stainless steel V2A	Stainless steel V2A	Stainless steel V2A	Stainless steel V2A
Stainless steel V2A	Stainless steel V2A	Stainless steel V2A	Stainless steel V2A
PUR cable	Connector S12	PUR cable	Connector S12
IP 68 / IP 69K	IP 68 / IP 69K	IP 68 / IP 69K	IP 68 / IP 69K
Embeddable	Embeddable	Embeddable	Embeddable
250 Hz	250 Hz	100 Hz	100 Hz
10 ... 30 VDC	10 ... 30 VDC	10 ... 30 VDC	10 ... 30 VDC
-25 ... +85°C / -13 ... +185°F	-25 ... +85°C / -13 ... +185°F	-25 ... +85°C / -13 ... +185°F	-25 ... +85°C / -13 ... +185°F
≤ 200 mA	≤ 200 mA	≤ 200 mA	≤ 200 mA
DW-AD-703-M30-303	DW-AS-703-M30-303	DW-AD-703-M30	DW-AS-703-M30-002
		DW-AD-701-M30	DW-AS-701-M30-002
		DW-AD-704-M30	
NPN NC		NPN NC	PNP NC, NPN NC

Inductive

Photoelectric

Safety

RFID

Connectivity

Accessories

Glossary

Index

EXTREME

FAMILY

FULL INOX

FULL INOX

HOUSING SIZE

M30

M30

OPERATING DISTANCE MM

40

40

INDUCTIVE

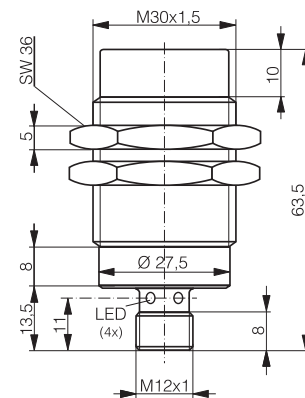
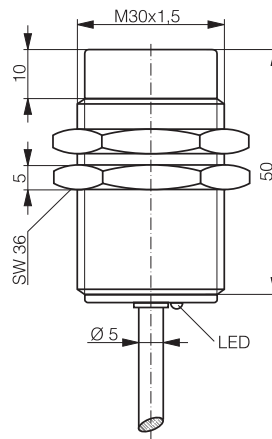

DATA

IO-Link

IO-Link

Housing material

Stainless steel V2A

Stainless steel V2A

Sensing face material

Stainless steel V2A

Stainless steel V2A

Connection

PUR cable

Connector S12

Degree of protection

IP 68 & IP 69K

IP 68 & IP 69K

Mounting

Non-embeddable

Non-embeddable

Max. switching frequency

90 Hz

90 Hz

Supply voltage range

10 ... 30 VDC

10 ... 30 VDC

Ambient temperature range

-25 ... +85°C / -13 ... +185°F

-25 ... +85°C / -13 ... +185°F

Output current

≤ 200 mA

≤ 200 mA

PNP NO

DW-AD-713-M30

DW-AS-713-M30-002

NPN NO

DW-AD-711-M30

DW-AS-711-M30-002

Other types available

PNP NC, NPN NC

PNP NC, NPN NC

EXTREME

FULL INOX	FULL INOX
C23	C23
7	7

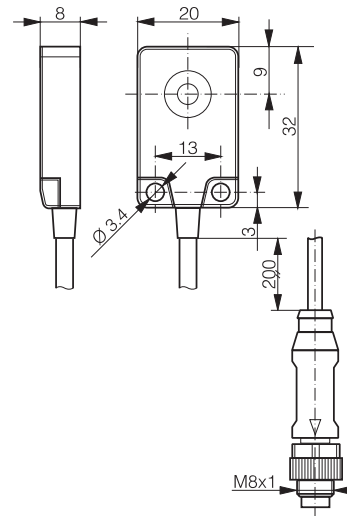
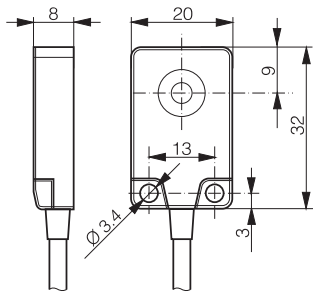

IO-Link	IO-Link
Stainless steel V4A/AISI/316L	Stainless steel V4A/AISI/316L
Stainless steel V4A/AISI/316L	Stainless steel V4A/AISI/316L
PUR cable	PUR cable / Connector S8
IP 68 & IP 69K	IP 68 & IP 69K
Embeddable	Embeddable
180 Hz	180 Hz
10 ... 30 VDC	10 ... 30 VDC
-25 ... +85°C / -13 ... +185°F	-25 ... +85°C / -13 ... +185°F
≤ 200 mA	≤ 200 mA
DW-AD-703-C23	DW-AV-703-C23-276
DW-AD-701-C23	DW-AV-701-C23-276

Inductive
Photoelectric
Safety
RFID
Connectivity
Accessories
Glossary
Index